

Coro zero v pro datasheet

LED recessed spotlight with fixed lens optics and 60° light cone (downlight non-tiltable) for hollow ceilings with revision. zero model for flush mounting. The spotlight is mounted with a separate mounting sleeve. Version with remote power supply unit, connection to external constant current power source (driver). Dimmable via customer-supplied dimmable power supply unit.

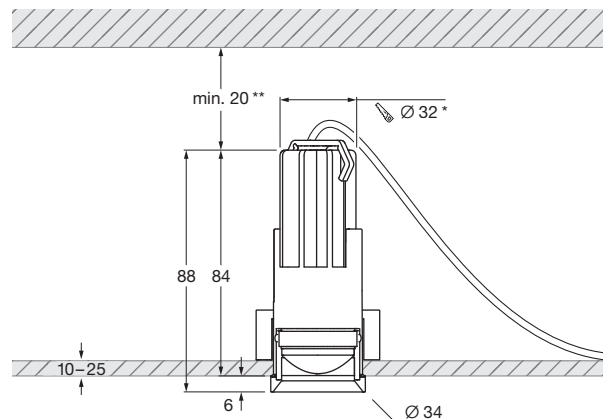
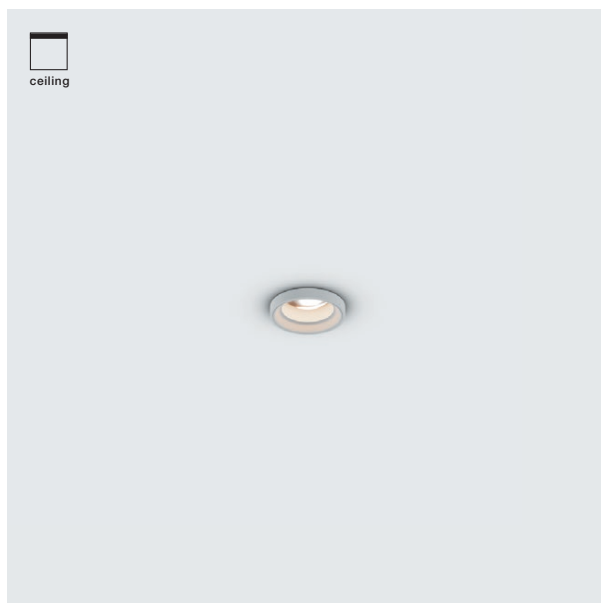

* cut-out dimensions

** minimum thermal distance, installation height depending on driver

dimensions in mm

technical data Coro zero v pro

properties	material	aluminium, glass, PVD coated, painted, plastic
	weight	0.1 kg
surface	head	bronze, matt gold, rose gold, matt silver, matt white, matt black, phantom, black phantom
Occhio LED	average life time	> 50.000 hrs
	energy efficiency class (luminous efficiency)	G (75 lm/W, @4000 K single color)
	power	LED 7 W
	color rendering index	CRI Ra 92
	color temperature (color consistency)	single color: 2700 K, 3000 K, 4000 K (2-step)
		color tune: 2200–3500 K (2-step) 2700–4000 K (2-step)
electricity	dimming	with suitable power supply unit
	connection	single color (1-channel): max. 390 mA / 18 VDC color tune (2-channel): max. 780 mA total current ($I_1 + I_2$) / 9 VDC per channel
	permitted operating conditions	ambient temperature 10–30°C, for indoor use only

Coro zero v pro
lighting effects

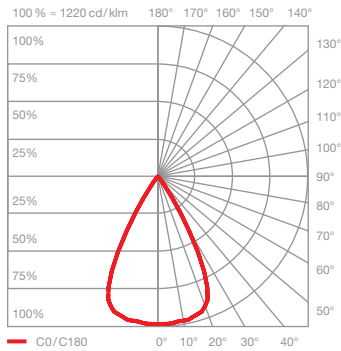
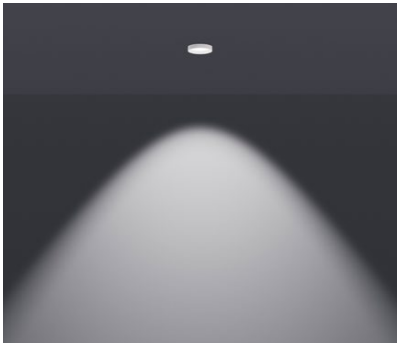

lens
direct light, beam angle approx. 60°

optics:	lens	
power:	high color	7 W
luminous flux:	2700 K	400 lm
	3000 K	420 lm
	4000 K	480 lm
	2200–3500 K	290–380 lm
	2700–4000 K	330–400 lm