

Coro zero v phase-cut datasheet

LED recessed downlight with fixed lens optic (non-tiltable). zero v downlight version for flush mounting in hollow ceilings with revision. The downlight is mounted with a separate mounting sleeve.

Version with remote power supply unit, connection to 230 VAC mains voltage. Dimmable via phase-cut dimmer. The color temperature can be configured to 2700 K, 3000 K or 4000 K when ordering.

The fixed lens optic has a light cone of 60°.

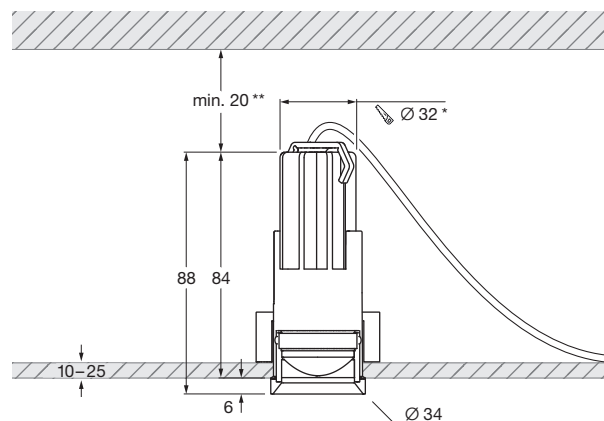
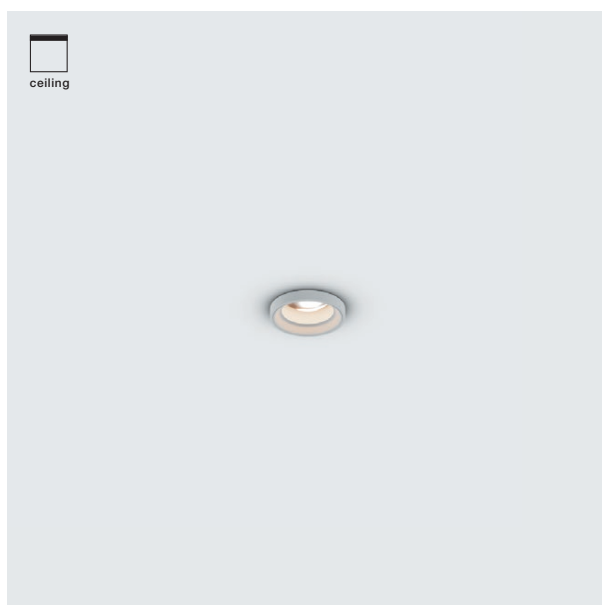

* cut-out dimensions
** minimum thermal distance, installation height depending on driver

dimensions in mm

technical data Coro zero v phase-cut

properties	material	aluminium, glass, PVD coated, painted, plastic
	weight	0.4 kg
surface	head	gold, matt gold, rose gold polished, matt silver, matt white, matt black, phantom polished, black phantom polished, dark chrome polished
Occhio LED	average life time	> 50.000 hrs
	energy efficiency class	This product contains a light source of energy efficiency class F (2700 K, 3000 K) or E (4000 K)
	power	LED 7 W (incl. Occhio power supply unit approx. 9 W, standby < 0.5 W)
	color rendering index	CRI Ra 92
	color temperature (color consistency)	2700K/3000K/4000 K (2-step)
electricity	dimming	via trailing-edge phasecut
	connection	230 VAC
	permitted operating conditions	ambient temperature 10–30°C, for indoor use only

Coro zero v phase-cut
lighting effects

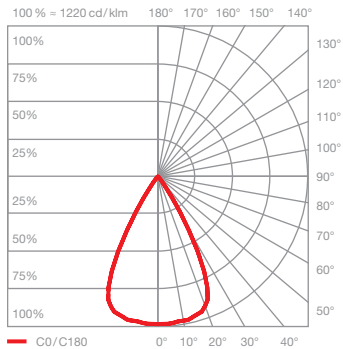
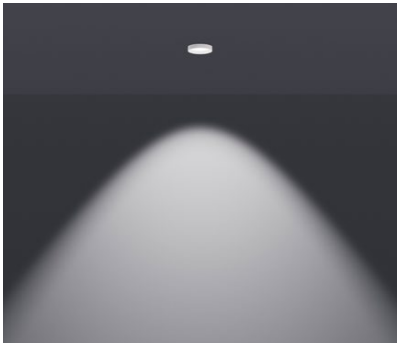

lens		
direct light, beam angle approx. 60°		
optics:	lens	
power:	high color	7 W
luminous flux:	2700 K	400 lm
	3000 K	420 lm
	4000 K	480 lm