

## Coro zero v »air« datasheet

LED recessed downlight with fixed lens optic (non-tiltable). zero v downlight version for flush mounting in hollow ceilings with revision. The downlight is mounted with a separate mounting sleeve.

Version with remote power supply unit, connection to 230 VAC mains voltage. Switching, dimming and »color tune« via Occhio air. The color temperature can be adjusted continuously between 2700–4000 K (optional 2200–3500 K). The fixed lens optic has a light cone of 60°.

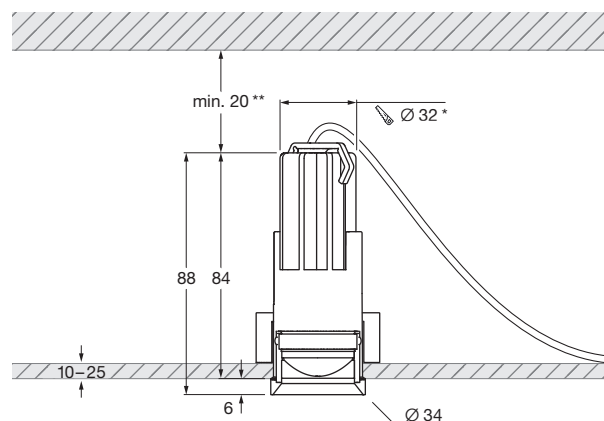
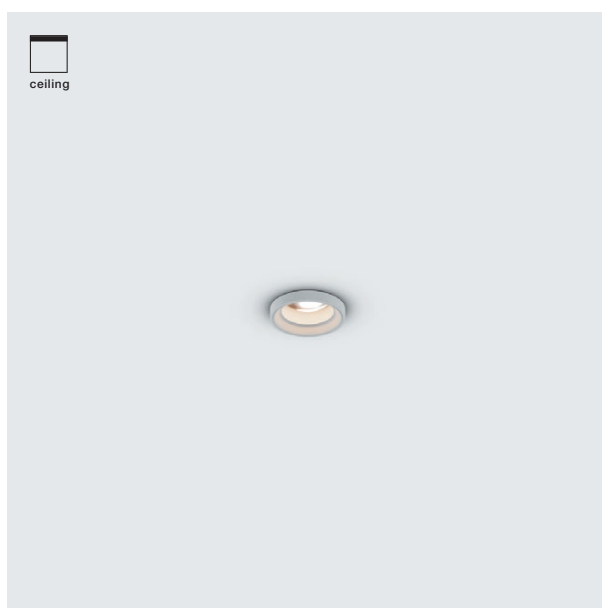

\* cut-out dimensions  
\*\* minimum thermal distance, installation height depending on driver

dimensions in mm

### technical data Coro zero v »air«

properties	material	aluminium, glass, PVD coated, painted, plastic	
	weight	0.4 kg	
surface	head	gold, matt gold, rose gold polished, matt silver, matt white, matt black, phantom polished, black phantom polished, dark chrome polished	
Occhio »color tune« LED	average life time	> 50.000 hrs	
	energy efficiency class	This product contains a light source of energy efficiency class F (2200–3500K) or E (2700–4000K)	
	power	LED 7 W (incl. Occhio power supply unit approx. 9 W, standby < 0.5 W)	
	color rendering index	CRI Ra 92	
	color temperature (color consistency)	color tune: 2200–3500 K (2-step)	2700–4000 K (2-step)
electricity	dimming	via Occhio air	
	connection	230 VAC	
	permitted operating conditions	ambient temperature 10–30°C, for indoor use only	

## Coro zero v »air« lighting effects

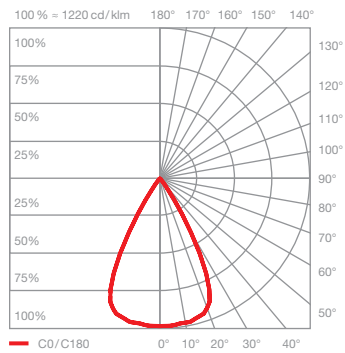
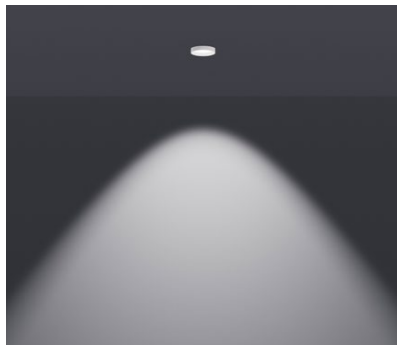

### lens

direct light, beam angle approx. 60°

optics: lens

power: high color 7 W

luminous flux: 2200–3500 K 290–380 lm  
2700–4000 K 330–400 lm