

## Coro alto up »air« datasheet

LED ceiling spotlight with cylindrical base and zoom optic (swivable). up version for surface mounting. Version with integrated power supply unit, connection to 230 V AC mains voltage. Switching, dimming and »color tune« via Occhio air. The color temperature can be adjusted continuously between 2700–4000 K (optional 2200–3500 K).

The zoom optic can be rotated by 360° (with end-stop), swiveled by 30° and the light cone can be adjusted continuously between 25–60°.

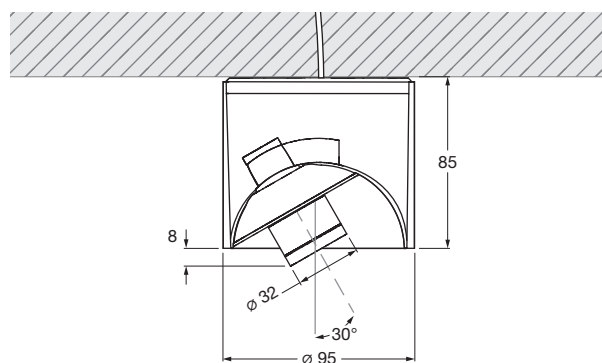

\* cut-out dimensions

dimensions in mm

### technical data Coro alto up »air«

properties	material	aluminium, glass, PVD coated, painted, plastic	
	turning range	360° (with stop)	
	mobility head	30°	
	weight	0.9 kg	
surface	head / zoom	gold, matt gold, rose gold polished, matt silver, matt white, matt black, phantom polished, black phantom polished, dark chrome polished	
	tube	matt white, matt black	
Occhio »color tune« LED	average life time	> 50.000 hrs	
	energy efficiency class	This product contains a light source of energy efficiency class F (2200–3500K) or E (2700–4000K)	
	power	LED 9W (incl. Occhio power supply unit approx. 12 W, standby < 0.5 W)	
	color rendering index	CRI Ra 92	
	color temperature (color consistency)	color tune: 2200–3500 K (2-step)	2700–4000 K (2-step)
electricity	dimming	via Occhio air	
	connection	230 V AC	
	permitted operating conditions	ambient temperature 10–30°C, for indoor use only	

## Coro alto up »air« lighting effects

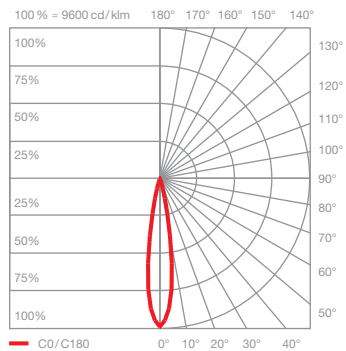
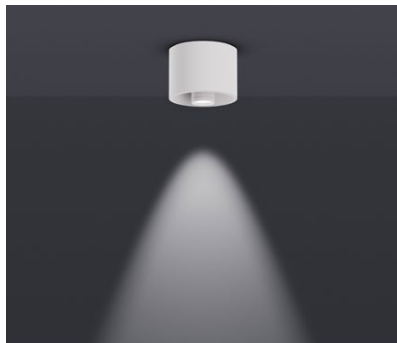

### **Z25** directed light (approx. 25°)

optics:	zoom lens	
power:	high color	9 W
luminous flux:	2200–3500 K	170–230 lm
	2700–4000 K	200–240 lm

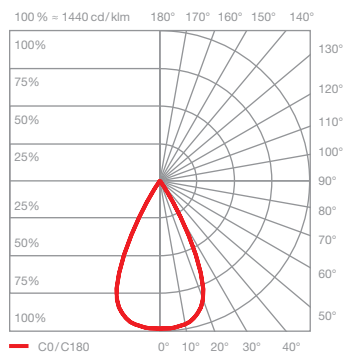
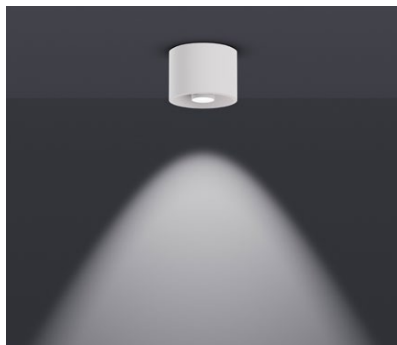

### **Z60** directed light (approx. 60°)

optics:	zoom lens	
power:	high color	9 W
luminous flux:	2200–3500 K	320–420 lm
	2700–4000 K	370–450 lm